

# AIR OUTLET SERVOMOTOR INSPECTION

1. REMOVE LOWER FINISH PANEL LH (See page [BO-69](#) )

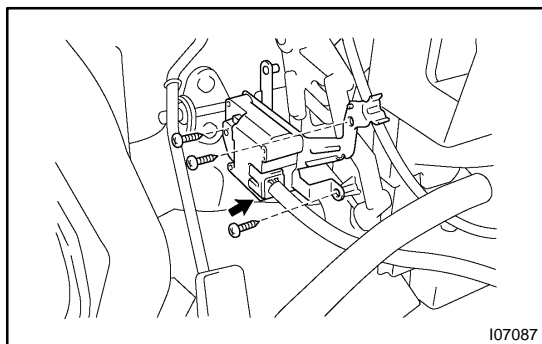

2. REMOVE AIR OUTLET SERVOMOTOR

- (a) Disconnect the connector.
- (b) Remove the 3 screws and servomotor.

3. **Auto A/C model:**  
**INSPECT AIR OUTLET CONTROL SERVOMOTOR CIRCUIT** (See page [DI-619](#) )

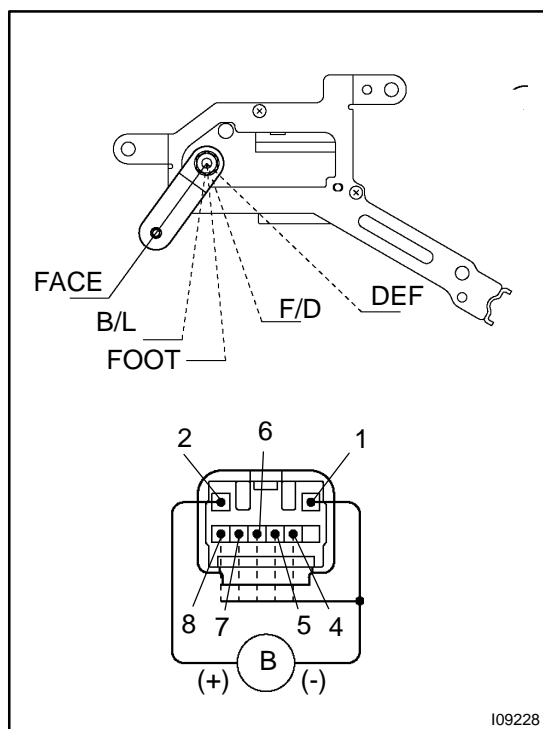

4. **Manual A/C model:**  
**INSPECT AIR OUTLET SERVOMOTOR**

Inspect servomotor operation.

- (1) Connect the positive (+) lead from the battery to terminal 2 and negative (-) lead to terminal 1.
- (2) Check the lever operation when the negative (-) lead is connected to the terminals shown below.

**HINT:**

The lever moves smoothly to the position for each mode.

Ground Terminals	Mode
8	DEF.
7	FOOT/DEF
6	FOOT
5	B/L
4	FACE

If resistance is not as specified, replace the servomotor.

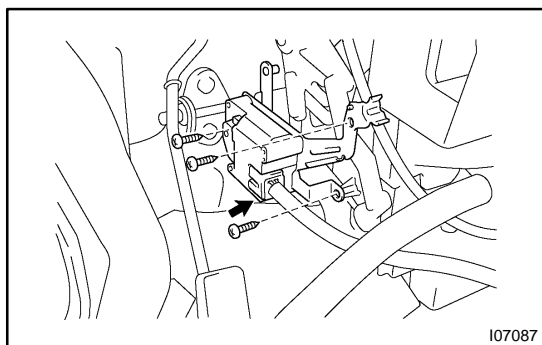

5. **INSTALL AIR OUTLET SERVOMOTOR**

- (a) Install the servomotor with the 3 screws.
- (b) Connect the connector.

6. **INSTALL LOWER FINISH PANEL LH** (See page [BO-76](#) )